

Soils Map

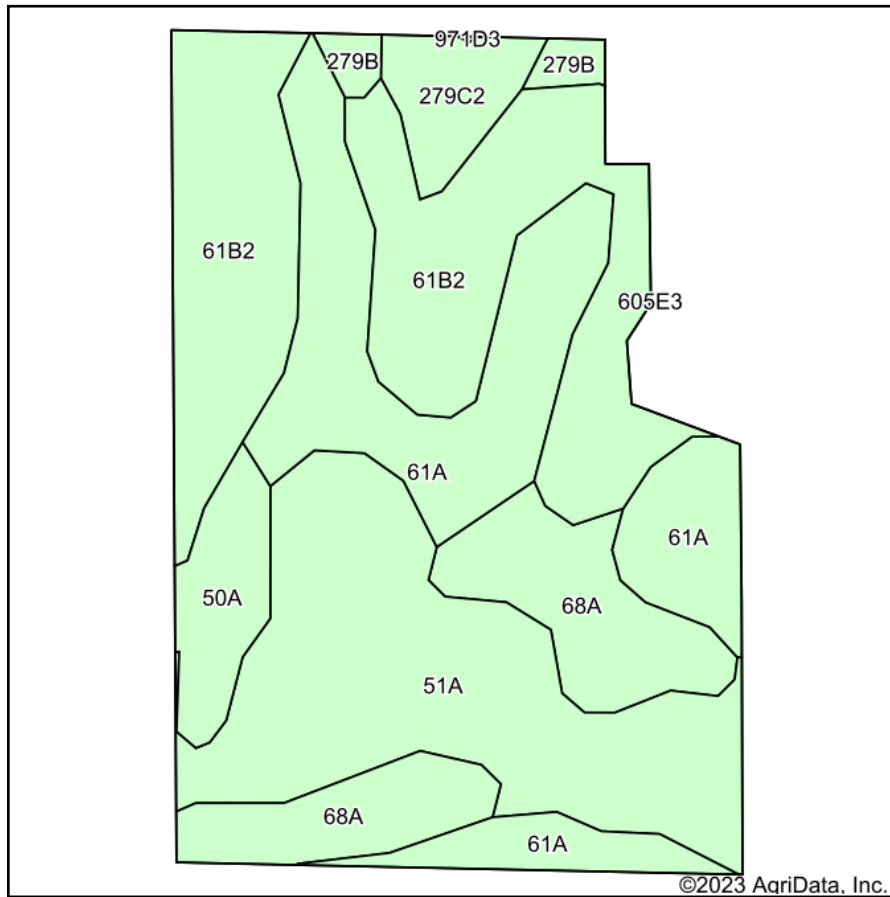

Soils data provided by USDA and NRCS.

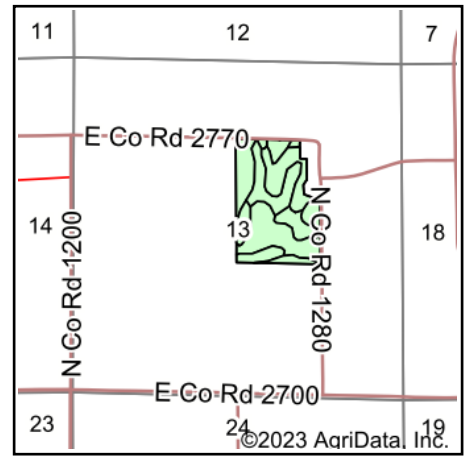

State: **Illinois**
 County: **Hancock**
 Location: **13-7N-8W**
 Township: **Appanoose**
 Acres: **55.93**
 Date: **9/13/2023**



Maps Provided By:



© AgriData, Inc. 2023

www.AgriDataInc.com



Area Symbol: IL067, Soil Area Version: 16

| Code | Soil Description | Acres | Percent of field | Subsoil rooting ^a | Corn Bu/A | Soybeans Bu/A | Wheat Bu/A | Oats Bu/A ^b | Sorghum ^c Bu/A | Alfalfa ^d hay, T/A | Grass-legume ^e hay, T/A | Crop productivity index for optimum management |
|------------------|---|-------|------------------|------------------------------|-----------|---------------|------------|------------------------|---------------------------|-------------------------------|------------------------------------|--|
| **61B2 | Atterberry silt loam, 2 to 5 percent slopes, eroded | 16.24 | 29.0% | FAV | **173 | **53 | **67 | **93 | 0 | 0.00 | **5.24 | **125 |
| 51A | Muscature silt loam, 0 to 2 percent slopes | 14.14 | 25.3% | FAV | 200 | 64 | 75 | 104 | 138 | 0.00 | 6.02 | 147 |
| 61A | Atterberry silt loam, 0 to 2 percent slopes | 12.91 | 23.1% | FAV | 182 | 56 | 71 | 98 | 0 | 0.00 | 5.52 | 132 |
| 68A | Sable silty clay loam, 0 to 2 percent slopes | 7.18 | 12.8% | FAV | 192 | 63 | 74 | 99 | 0 | 0.00 | 5.77 | 143 |
| 50A | Virden silty clay loam, 0 to 2 percent slopes | 2.54 | 4.5% | FAV | 182 | 59 | 71 | 93 | 0 | 0.00 | 5.27 | 135 |
| **279C2 | Rozetta silt loam, 5 to 10 percent slopes, eroded | 2.08 | 3.7% | FAV | **153 | **47 | **60 | **78 | 0 | **4.90 | 0.00 | **112 |
| **279B | Rozetta silt loam, 2 to 5 percent slopes | 0.84 | 1.5% | FAV | **162 | **50 | **64 | **83 | 0 | **5.22 | 0.00 | **119 |
| Weighted Average | | | | | 183.8 | 57.8 | 70.7 | 97 | 34.9 | 0.26 | 5.30 | 134.4 |

Table: Optimum Crop Productivity Ratings for Illinois Soil by K.R. Olson and J.M. Lang, Office of Research, ACES, University of Illinois at Champaign-Urbana. Version: 1/2/2012 Amended Table S2 B811

Crop yields and productivity indices for optimum management (B811) are maintained at the following NRES web site: <http://soilproductivity.nres.illinois.edu/>

** Indexes adjusted for slope and erosion according to Bulletin 811 Table S3

^a UNF = unfavorable; FAV = favorable

^b Soils in the southern region were not rated for oats and are shown with a zero "0".

^c Soils in the northern region or in both regions were not rated for grain sorghum and are shown with a zero "0".

^d Soils in the poorly drained group were not rated for alfalfa and are shown with a zero "0".

^e Soils in the well drained group were not rated for grass-legume and are shown with a zero "0".

Soils data provided by USDA and NRCS. Soils data provided by University of Illinois at Champaign-Urbana.